



ARTS COUNCIL OF NEW WESTMINSTER

PO Box 16003, New Westminster, BC V3M 6V6

info@acnw.ca | acnw.ca | 604-525-3244

At the Arts Council of New Westminster, we live and work on the unceded, traditional territories of the Coast Salish peoples of the QayQayt (qiqéyt) Nation as well as all Coast Salish Nations.

THE GALLERY AT QUEEN'S PARK
EXHIBITION APPLICATION PACKAGE

CALL FOR ARTISTS 2022

The Arts Council of New Westminster aims to have exhibitions that feature a variety of visual arts by a wide range of artists from the Metro Vancouver region. The exhibition program aims to reflect both the cultural and artistic diversity of contemporary art and serve as an educational forum for New Westminster and surrounding communities. This program is open to applications from both established and emerging artists.

The Arts Council wishes to highlight the diversity of our community, and in order to break down any exclusionary barriers and create a platform for marginalized voices, artists on the LGBTQ spectrum, non-binary artists, artists of colour, Indigenous artists, and disabled artists, are strongly encouraged to submit.

Submissions deadline:
4:00 pm - Monday August 30, 2021



ARTS COUNCIL OF NEW WESTMINSTER

PO Box 16003, New Westminister, BC V3M 6V6

info@acnw.ca | acnw.ca | 604-525-3244

Overview:

The ACNW operates a picturesque gallery in the Centennial Lodge, Queen's Park, known as **The Gallery at Queen's Park**. Our monthly exhibition program features a wide range of visual arts by local and emerging artists.

This Call is for monthly exhibitions between February 2022 and November 2022 inclusive. Exhibitions typically open on the first Wednesday of each month and generally close on the last Sunday of the month.

The Gallery at Queen's Park has one exhibition space, known as the Eileen Montague Room (labelled as the Main Gallery Space, see page 6). There is a total linear hanging space of approximately 15 m (49.5 ft). In certain instances, the Gallery Exhibition Selection Committee may pair two selected artists during the exhibition period.

Artwork must be suitably framed, ready for hanging, or, if three-dimensional, appropriately mounted or otherwise prepared for presentation.

As a community gallery, volunteer staff maintain the Gallery's operating hours. Therefore, all selected artists are expected to sit as a Gallery Attendant on Saturdays and Sundays from 10:00 am - 2:00 pm for the duration of their exhibition.

Eligibility:

- To apply to this Call, you are not required to be a member of the Arts Council of New Westminster.
- To exhibit, you must be a current member of the Arts Council of New Westminster at the time of your exhibition.
- Artists whose work has already been exhibited in the Gallery are invited to apply, allowing a 3-year interim between applications.

PLEASE NOTE: The proposed exhibition submission must not have been showcased in New Westminister in the preceding 12 months nor (upon acceptance) be displayed in any other New Westminister gallery during the exhibiting year.

Budget:

- The Council does not charge for exhibiting, nor does it pay an artist to exhibit. The Council welcomes a 25% donation on total sales of artwork in the Gallery.
- The Gallery at Queen's Park will pay an honorarium of \$150 for public programming during the exhibition, a part of the Inter/action Artist Learning Series.



ARTS COUNCIL OF NEW WESTMINSTER

PO Box 16003, New Westminster, BC V3M 6V6

info@acnw.ca | acnw.ca | 604-525-3244

How to Apply for an Exhibition:

The Gallery Exhibitions Selection Committee (GESC) meets each September to consider applications for the following calendar year. A well-prepared proposal helps in the selection.

The ACNW is dedicated to inclusion and access to the submissions processes and will accept applications in:

- Zipped folder (no larger than 5MB) or by file hosting service (eg. WeTransfer, Google Drive)
- Single PDF
- Video submission. No more than 10 minutes and must be below 200MB
- In-person or Oral application: Please email us at least 10 business days before the application deadline. We may not be able to accommodate requests made any later.

For additional information on application and access accommodations, please email or call Stephen O'Shea: info@acnw.ca or 604-525-3244

To be considered at the next GESC meeting, please submit the following:

- A Curriculum Vitae (3 pages max.) including a list of your previous exhibition and education experience. Please include: mailing address, phone number, email, website
- A selection of 8-10 digital images of proposed work you wish to exhibit. Digital images should be jpg format at 150 dpi; each image should be a maximum of 800 x 600 pixels. Image files should be clearly labelled with your **Name, the Title of Work, Size** in inches and **Medium**. Example: Artist-Title-Size-Medium.jpg
- An Artist Statement (up to 500 words) giving your aims and objectives as an artist in relation to your work.
- An Artist Biography (up to 500 words) to establish a better understanding of your background and experience.
- A written proposal for public programming to be produced and hosted by the artist at the Gallery. The public programming event must occur during regular posted open hours, on a Sunday, during the exhibit. Proposed public programming may be events such as an artist talk, performance art, theoretical or technical seminar, live drawing/painting, social practice, etc.

Submit via email to info@acnw.ca with “**Exhibition Submission – The Gallery at Queen’s Park**” in the subject line. **Deadline for submission is 4:00pm on Monday August 30, 2021.** All applications will be notified of results.

Please note: Applications will not be rolled over to the following year. To be considered for an application for the following year, please re-apply.



ARTS COUNCIL OF NEW WESTMINSTER

PO Box 16003, New Westminister, BC V3M 6V6

info@acnw.ca | acnw.ca | 604-525-3244

The Selection/Exhibition Process:

The GESC will meet in September 2021 to consider all applications received. All applications will receive a reply by email, stating whether the work has been accepted. If your application has been successful, you will be contacted by telephone, an exhibition date will be confirmed, and a contract will be sent to you. This contract will outline your responsibilities and provide other details and dates. A signed contract is required before the exhibition can proceed.

Application Tips:

- Be sure that all documents include your name, a working title of the proposed exhibition and complete contact information; phone number, email address, website and mailing address, including postal code.
- Email submissions are preferred. For hard copy submissions, please phone the Gallery at 604-525-3244 for equitable access procedures.
- DO NOT send composite images or prepared slideshows.
- Please test all documents on a PC computer to ensure compatibility.

Submit your application via email to: info@acnw.ca

Estimated Timeline:

July 1	Call for Artists launched
August 30	Deadline to submit
Mid-September	Gallery Exhibition Selection Committee meets
Early October	Artists contacted
Late October	Exhibition dates confirmed, contracts signed and returned
February – Nov 2022	Exhibition schedule

Contact:

All enquiries should be directed to:
Stephen O'Shea, Executive Director
Phone: 604-525-3244
info@acnw.ca

For more information about The Gallery at Queen's Park, visit www.acnw.ca/gallery



ARTS COUNCIL OF NEW WESTMINSTER

PO Box 16003, New Westminister, BC V3M 6V6

info@acnw.ca | acnw.ca | 604-525-3244

Technical Information:

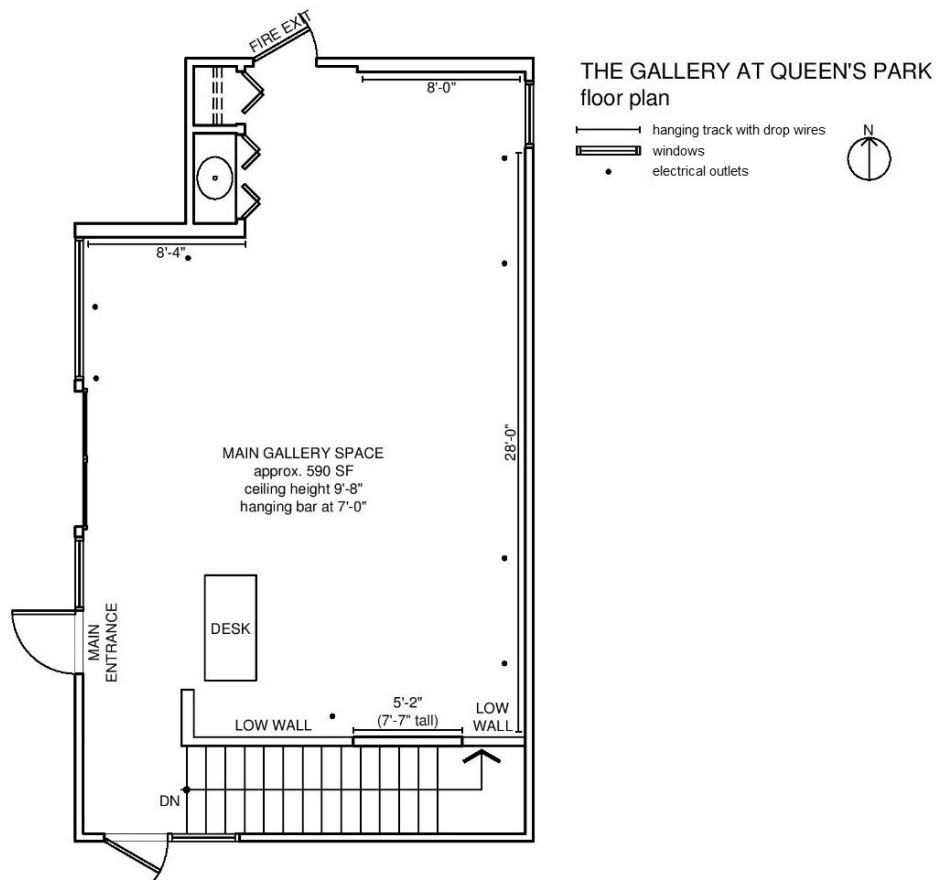

The Gallery does not have a Loading Bay. All shipments of artwork must fit through the Main Entrance (34"x80").

All two-dimensional artwork is installed using a hanging track system with drop wires and track lighting.

The Gallery has an assortment of nine plinths to display 3-dimensional artwork.

A limited selection of tools and equipment can be provided by The Gallery. Other requirements are the responsibility of the artist.

Please note that the main floor of the Gallery is an accessible space with an at-grade entrance.

For individuals with environmental sensitivities and/or environmental illnesses, the space is operated in a scent-reduced manner.