



ARTS COUNCIL OF NEW WESTMINSTER

PO Box 16003, New Westminster, BC V3M 6V6

info@acnw.ca | acnw.ca | 604-525-3244

At the Arts Council of New Westminster, we live and work on the unceded, traditional territories of the Coast Salish peoples of the QayQayt (qiqéyt) Nation as well as all Coast Salish Nations.

THE GALLERY AT QUEEN'S PARK
ARTISTS-IN-RESIDENCE

CALL FOR PROPOSALS 2020

The Arts Council of New Westminster aims to have an Artist-in-Residence program that feature a variety of disciplines by a wide range of artists from New Westminster. The Artist-In-Residence program aims to reflect both the cultural and artistic diversity of contemporary art and to serve as an educational forum for the citizens of New Westminster and surrounding communities. This program is open to applications from both established and emerging artists living and/or working in New Westminster. For clarity: this is an artist development program, you do not need to be an established artist. This is a opportunity to develop as an artist, and no previous experience is expected.

The Arts Council wishes to highlight how diverse our community is, and in order to break down any exclusionary barriers and create a platform for marginalized voices, artists on the LGBTQ spectrum, non-binary artists, artists of colour, Indigenous artists, and disabled artists, are strongly encouraged to submit.

**Submissions will be received up to 4:00pm on
Friday January 31, 2020**



ARTS COUNCIL OF NEW WESTMINSTER

PO Box 16003, New Westminister, BC V3M 6V6

info@acnw.ca | acnw.ca | 604-525-3244

Overview:

The ACNW operates a picturesque gallery in the Centennial Lodge, Queen's Park known as **The Gallery at Queen's Park**, which features a wide range of visual arts by local and emerging artists in exhibitions which change monthly.

The ACNW is seeking to provide New Westminister artists and local not-for-profit arts organizations the opportunity to use the Lower Studio space in The Gallery at Queen's Park free of charge in exchange for a weekly public programming event (2 hours) that engages the community. Collaborations between artists and community groups are welcome.

Selected eligible artists and organizations will have 24-hour non-exclusive access to the Lower Studio space. *All successful applicants will be required to be members of the Arts Council of New Westminister.*

As a community gallery, the gallery's opening hours are maintained by volunteer staff, therefore the Artist-in-Residence will be expected to work collaboratively within the operations of the Gallery for the duration of their residency.

Eligibility:

- To apply to this Call, you are not required to be a member of the Arts Council of New Westminister.
- To be considered for this program, you must live and/or work in New Westminister.
- To be in-residence, you must be a current member of the Arts Council of New Westminister at the time of your residency.
- Artists whose work has already been exhibited in the gallery are invited to apply, allowing a 3-year interim between applications.

Budget:

- The Council does not charge for artist-in-residence program, nor does it pay an artist to participate.
- The Gallery at Queen's Park will pay an honorarium of \$75 for public programming during the residency.



ARTS COUNCIL OF NEW WESTMINSTER

PO Box 16003, New Westminister, BC V3M 6V6

info@acnw.ca | acnw.ca | 604-525-3244

How to Apply:

The Gallery Exhibition Selection Committee (GESC) will meet in February to consider applications for the following year. A well-prepared proposal helps in the selection.

To be considered at the next GESC meeting, please submit a completed Application Form (found in the PDF package):

- Applicant's Background:
For Individual Artists: Artistic practice and objectives with short biography and/or professional artist CV
For Arts Organizations: Organization history including mission statement, years of operation and a brief description of the organization's current programs and services
- Public Programming description:
What the project is about, your plan for public programming in the space (readings, publications, book or zine launches, performances, film screenings, pop-up events, artist talks, performance art, theoretical or technical seminar, live drawing/painting, social practice, workshops, classes, community meetings etc.), and how it will engage/benefit the community
- Your requested start date and occupancy period/time frame of use of the Lower Studio
- Any proposed collaboration with other artists or groups, if applicable
- Contact information (name, mailing address, phone number, email, website)
- Please indicate if you are currently an ACNW member

Please include all written material as PDF files and submit via email to info@acnw.ca with "**The Gallery at Queen's Park – Artists in Residence**" in the subject line. Please ensure that attachments total less than 5MB.

Deadlines for submission is 4:00pm on January 31, 2020. Proposals received by January 31, 2020 will be reviewed with preliminary decisions announced by February 28, 2020. Following that time, proposals will be accepted and reviewed on a first come, first serve basis. All submissions will be juried by a panel of professional artists, educators, and administrators. **Please note: All successful applicants will be required to be members of the Arts Council of New Westminster.**

The Selection Process:

The GESC will meet in February 2020 to consider all applications received. All applications will receive a reply by email, stating whether the work has been accepted. If your application has been successful, you will be contacted by telephone, a term length for residency will be confirmed, and a contract will be sent to you. This contract will outline your responsibilities and providing other details and dates. A signed contract is required before the residency can proceed.



ARTS COUNCIL OF NEW WESTMINSTER

PO Box 16003, New Westminster, BC V3M 6V6

info@acnw.ca | acnw.ca | 604-525-3244

Application Tips:

- Be sure that all documents include your name, complete contact information; phone number, email address, website and postal code.
- Email submissions are preferred. For physical submissions, please phone the gallery at 604-525-3244 for equitable access procedures.
- DO NOT send composite images or prepared slideshows
- Please test all documents on a PC computer to ensure compatibility

Submit your application via email to: info@acnw.ca

Estimated Timeline:

December 1, 2019	Call to Proposals Launched
January 31, 2020	Deadline to submit
Early February	Gallery Exhibition Selection Committee meets
Late February	Artists contacted
Early March	Residency dates confirmed, contracts signed and returned
March 15 th , 2020 & onward	Residency/Public Programming begins

Contact:

All enquiries should be directed to:
Stephen O'Shea, Executive Director
Phone: 604 525 3244
info@acnw.ca

For more information about The Gallery at Queen's Park, visit www.acnw.ca/gallery



ARTS COUNCIL OF NEW WESTMINSTER

PO Box 16003, New Westminster, BC V3M 6V6

info@acnw.ca | acnw.ca | 604-525-3244

The Gallery at Queen's Park – Artists in Residence
CALL FOR STUDIO PROPOSALS – APPLICATION FORM

Artist Name:	
Biography C/V (300 words)	
Proposed Public Programming (300 words)	
Proposed weekly public programming activity:	
Week 1	
Week 2	
Week 3	
Week 4	
Week 5	
Week 6	
Week 7	
Week 8	
Week 9	
Week 10	
Week 11	
Week 12	
Contact information: Name: Address:	Phone: Email: Website:
Are you currently an ACNW member: Yes No	
Length of Residence Requests (in weeks):	



ARTS COUNCIL OF NEW WESTMINSTER
PO Box 16003, New Westminister, BC V3M 6V6
info@acnw.ca | acnw.ca | 604-525-3244

Technical Information:

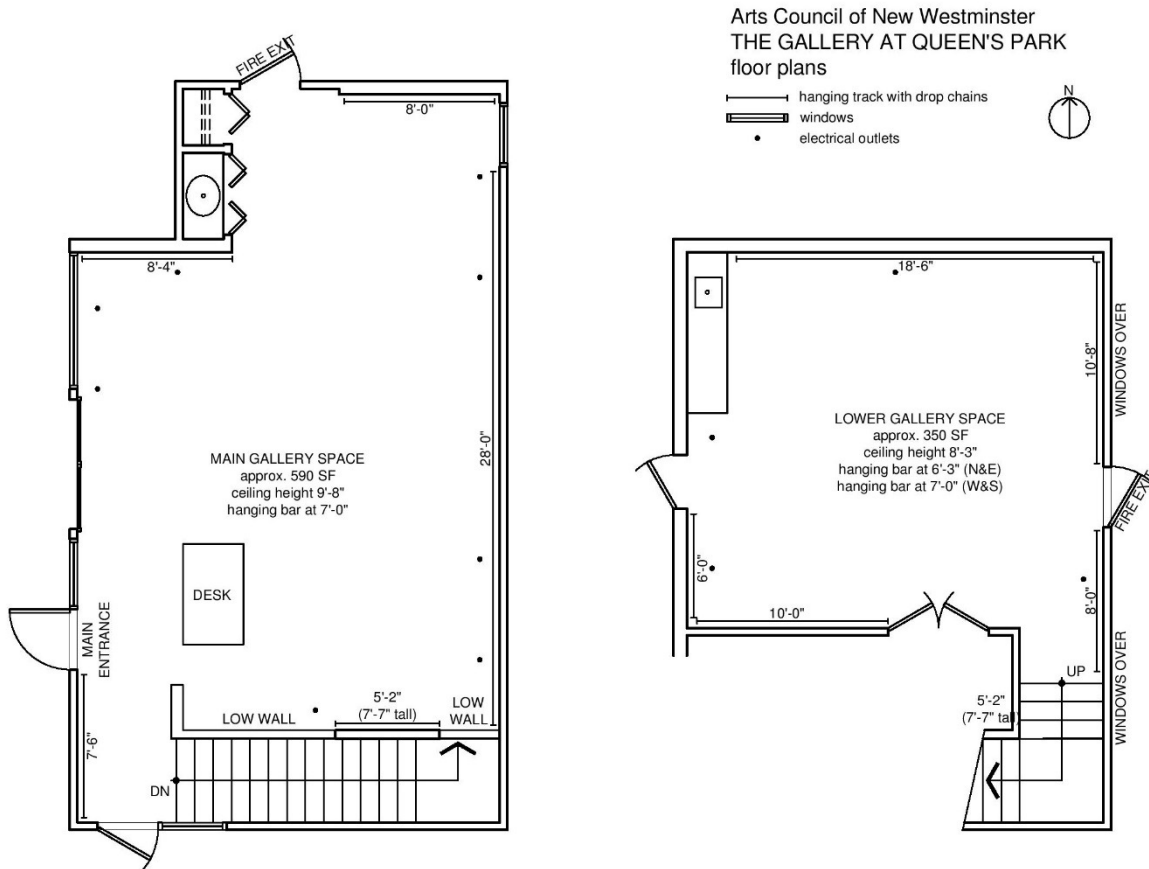

The Gallery does not have a Loading Bay. All shipments of artwork must fit through the Main Entrance (34"x80").

All 2-dimensional artwork is hung using a hanging track system with drop chains. Track lighting is available in both spaces.

The Gallery has an assortment of twelve plinths to display 3-dimensional artwork.

A limited selection of tools and equipment can be provided by The Gallery. Other requirements are the responsibility of the artist.

Please note that the main floor of the Gallery is an accessible space with an at-grade entrance however the Lower Gallery Space is not accessible to individuals with wheelchair or other mobility aids.

For individuals with environmental sensitivities and/or environmental illnesses, the space is operated in a scent-reduced manner.